



SonicWALL Secure Remote Access Series

SMB에 최적화된 SSL VPN 솔루션

언제 어디서나 업무의 연속성을 유지하여 기업 생산성을 극대화!

특징

- 원격접속을 위한 완벽한 가상 통합
- 클라이언트리스 연결성
- NetExtender 기술 (네트워크 레벨의 리소스, 서비스, 어플리케이션 접속)
- 세밀한 정책 구성 제어
- 퍼스널 웹 포탈
- 원격 지원 (Virtual Assist 이용)
- 원격 PC 제어
- 웹 어플리케이션 방화벽(WAF) 서비스
- 토큰 없이 복수 인증 제공 (One-Time Password 기본 제공)
- 모바일 디바이스 지원
- 통합 정책 관리
- SonicWALL Clean VPN™

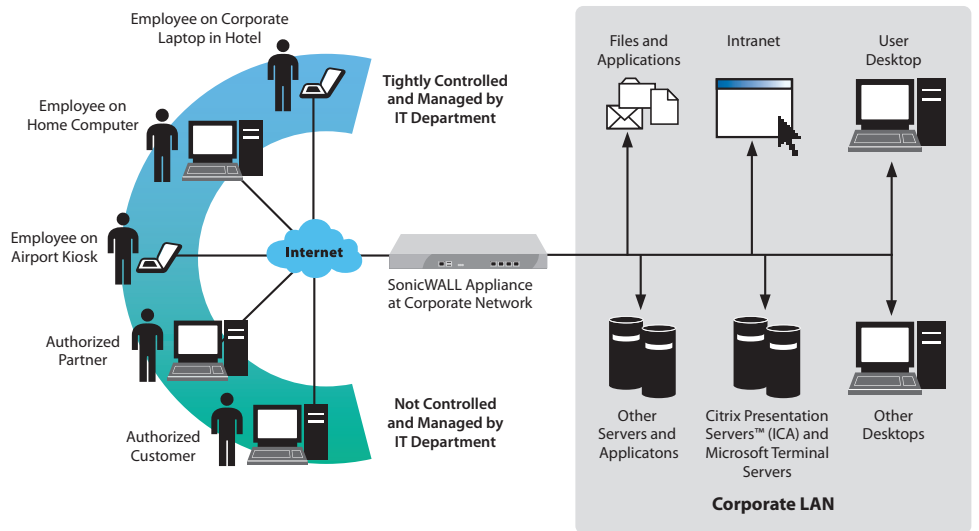

부가기능 - Web Application Firewall

특징

- Open Web Application Security Project (OWASP) Top 10 취약점 보안
 - PCI DSS 6.6과 업계 표준 포함
- Cross-site scription 보호
- 자동 시그니처 업데이트
- 강력한 인증과 권한 제어
- 정보 공개 보호
- 다이나믹한 데시보드
- 유연한 정책 설정
- 종합적인 감사 로그
- 세션 매니지먼트
- 위협 회피 수단 제공
- HTTPS inspection
- 엑셀레이터 기능 포함

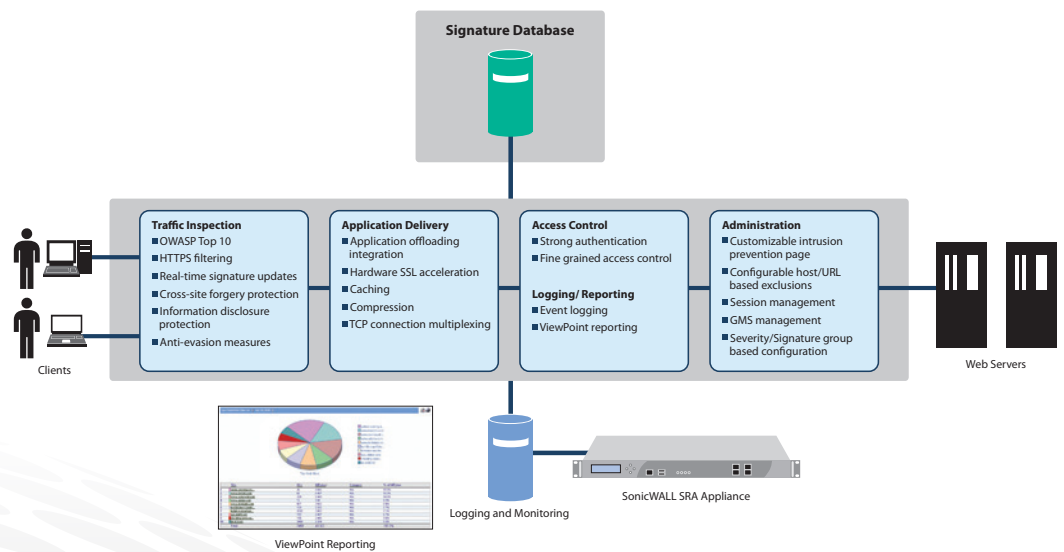



SRA 1200



SRA 4200

Specifications

Appliances

Secure Remote Access 1200

Secure Remote Access 4200

Web Application Firewall Subscription Required

Web Application Firewall Capacity

SRA 1200 Throughput: 15 Mbps

SRA 1200 Back-end Servers Supported: Unrestricted, recommend 1-5*

SRA 4200 Throughput: 50 Mbps

SRA 4200 Back-end Servers Supported: Unrestricted, recommend 5-10*

**Actual number of Web servers will depend on your network environment, policy configuration and Web server configuration.*

SonicWALL Secure Remote Access Series

Performance

SRA 1200	Recommended for organizations with 50 or fewer employees
Concurrent User License	Starts with 5 concurrent users. Additional user licenses available in 1, 5, and 10 user increments.
Maximum allowable concurrent Virtual Assist technicians	10
Maximum Concurrent Users	50
SRA 4200	Recommended for organizations with 500 or fewer employees
Concurrent User License	Starts with 25 concurrent users. Additional user licenses available in 10, 25, and 100 user increments.
Maximum allowable concurrent Virtual Assist technicians	25
Maximum Concurrent Users	500

Hardware

Hardened Security Appliance

SRA 1200	Yes
SRA 4200	Yes

Cryptographic Hardware Acceleration

SRA 1200	No
SRA 4200	Yes

Interfaces

SRA 1200	(2) Gigabit Ethernet, (2) USB, (1) Console
SRA 4200	(4) Gigabit Ethernet, (2) USB, (1) Console

Processors

SRA 1200	x86 main processor
SRA 4200	x86 main processor, cryptographic accelerator

Memory (RAM)

SRA 1200	1 GB
SRA 4200	2 GB

Memory (RAM)

SRA 1200	1 GB
SRA 4200	1 GB

Key Features

Applications Supported	
Proxy	Citrix (ICA), HTTP, HTTPS, FTP, SSH, Telnet, RDP, VNC, Windows® file sharing (Windows SMB/CIFS)
NetExtender	Any TCP/IP based application: ICMP, VoIP, IMAP, POP, SMTP, etc.
Encryption	DES (128), 3DES (128, 256), AES (128, 192, 256), ARC4 (128), MD5, SHA-1
Authentication	RSA, Vasco, One-time Passwords, Internal user database RADIUS, LDAP, Microsoft, Active Directory, Windows NT Domain
Multiple Domain Support	Yes
Multiple Portal Support	Yes
Fine Grain Access control	At the user, user group and network resource level
Session Security	Inactivity timeouts prevent unauthorized use of inactive sessions
Certificates	
Server	Self-signed with editable common name and imported from third parties
Client	Optional client certificates supported
Cache Cleaner	Configurable. Upon logout all cached downloads, cookies and URLs downloaded through the SSL tunnel are erased from the remote computer
Client PC Operating Systems Supported	
Proxy	All operating systems
NetExtender	Windows 2000, 2003, XP/Vista (32-bit and 64-bit), 7 (32-bit and 64-bit), Win Mobile 6.5 (Pocket PC), Win Mobile 6.5 (Classic/Professional), MacOS 10.4+ and SnowLeopard (PowerPC and Intel), Linux Fedora Core 3+ / Ubuntu 7+ / OpenSUSE
Web Browsers Supported	Microsoft Internet Explorer, Firefox Mozilla
Personalized Portal	The remote user sees only those resources that the administrator has granted access to based on company policy
Management	Web GUI (HTTP, HTTPS), Send syslog and heartbeat messages to GMS (4.0 and higher) SNMP Support
Usage Monitoring	Graphical monitoring of memory, CPU, users and bandwidth usage
Logging	Detailed logging in an easy-to-read format, Syslog supported email alerts
Single-Arm Mode	Yes
SonicWALL Virtual Assist or Virtual Access (licensed together)	Connection to remote PC, chat, FTP and diagnostic tools
IPv6 Support	Basic
Application offloading	Yes
Web Application Firewall	Yes